

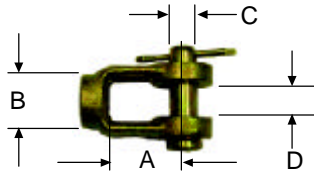

REPLACEMENT PARTS

Committed
To Quality...

CLEVIS ASSEMBLIES



CLEVIS PART NO	PIN ONLY PART NO.	DIM. A	DIM B	DIM C	DIM D
90007	90045	1.67"	M16 x 1.5	14 mm	0.56"
90013	90020	1.25"	5/8" - 18UNF	0.50"	0.56"
90018	90021	1.25"	5/8" - 18UNF	0.625"	0.56"
90019	90020	1.25"	1/2" - 20UNF	0.50"	0.56"
90040	90020	1.67"	5/8" - 18UNF	0.50"	0.56"
90044	90045	1.25"	5/8" - 18UNF	14 mm	0.56"
90058	90020	1.55"	M16 x 1.5	0.50"	0.56"
90059	90021	1.55"	1/2" - 20UNF	0.625"	0.56"
90062	90171	1.55"	3/4" - 16UNF	0.50"	0.81"
90063	90021	1.25"	3/4" - 16UNF	0.625"	0.56"
90064	90081	1.25"	3/4" - 16UNF	0.75"	0.81"
90071	90020	1.25"	M16 x 1.5	0.50"	0.56"
90076	90045	1.67"	M16 x 1.5	14 mm	0.56"
90077	90045	1.67"	5/8" - 18UNF	14 mm	0.56"
90105	90021	1.67"	5/8" - 18UNF	0.625"	0.56"

BOOT KITS



PART NO	TYPE
95107	N/A

SERVICE PUSH ROD



PART NO	TYPE
91203	12
91603	16
92003	20
92403	24
93003	30
93603	36

RELEASE TOOLS



PART NO	TYPE
90014	2 1/2" Stroke
90229	3" Stroke
90073	Type 36

PLUGS



PART NO	TYPE
90033	1/8" NPTF Plug
90061	Dustplug (24,30)
90186	Dustplug (36)

SERVICE RETURN SPRINGS



PART NO	TYPE
90016	12, 16
90003	20, 24, 30 (barrel)
90005	20, 24, 30 (cone)
90152	36, 24ELS, 30ELS

CLAMP BAND KITS



PART NO	TYPE
91211	12
91611	16
92011	20
92411	24
93011	30
93611	36
90001	Clamp Bolt
90002	Clamp Nut

PRESSURE HOUSING



PART NO	TYPE
91208	12
91608	16
92008	20
92408	24
92432	24ELS
93008	30
93032	30ELS
93608	36

NON-PRESSURE HOUSING



PART NO	TYPE
91207	12
91607	16
92007	20
92407	24
92432	24ELS
93007	30
93032	30ELS
93607	36